



PELLA INSTALLATION INSTRUCTIONS - ADVANCED PERFORMANCE

Nail Fin, Nail Fin with J-Channel and EnduraClad Exterior Trim with Nail Fin Windows

THE FOLLOWING INSTALLATION METHODS ARE INCLUDED IN THIS BOOKLET:

New Construction Installation After Building Wrap for Nail Fin Windows

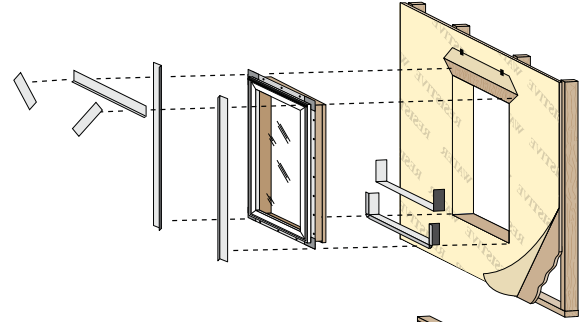

New Construction Installation Before Building Wrap for Nail Fin Windows

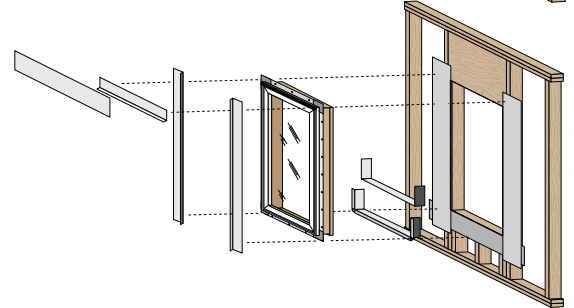

New Construction Installation with Water Resistant Sheathing for Nail Fin Windows

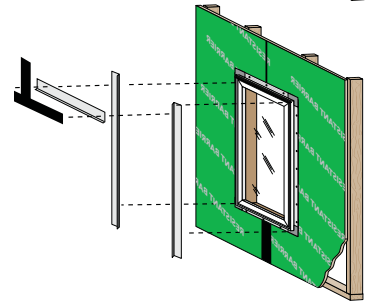

New Construction Installation in Masonry Construction for Nail Fin Windows

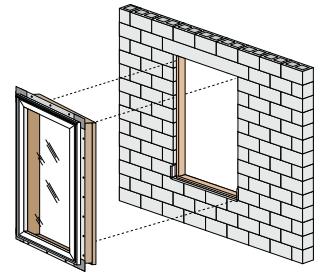

Full Frame Replacement after Brickmould/trim Removal or Siding cut-back for Nail Fin Windows

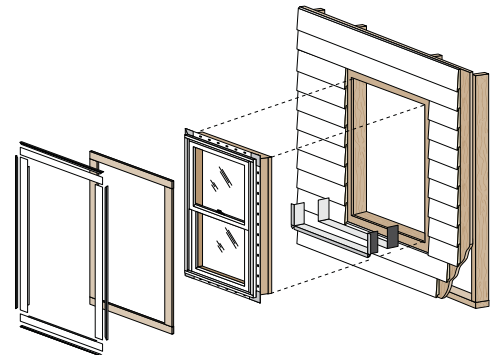

These instructions were developed and tested for use with wall systems designed to manage water. ***These instructions are not to be used with any other construction methods or window frame types.*** Installation instructions for use with other construction methods or frame types may be obtained from Pella Corporation, your local Pella® retailer or www.installpella.com. Building designs, construction methods, building materials, and site conditions unique to your project may require an installation method different from these instructions and/or additional care. Determining the appropriate installation method is the responsibility of you, your architect, or construction professional.



Always read the Limited Warranty before purchasing or installing Pella® products. By installing this product, you are acknowledging that this Limited Warranty is part of the terms of the sale. Failure to comply with all Pella installation and maintenance instructions may void your Pella product warranty. See Limited Warranty for complete details at www.pella.com/warranty.



FULL FRAME REMOVAL WHEN PREPARING TO INSTALL A NEW NAIL FIN WINDOW

This method of Full Frame Removal involves removing the sash and entire frame of the existing window from the wall. The resulting opening is the original rough opening. The existing window nailing fins are usually nailed to the studs in frame construction with siding, brick veneer or other exterior material applied over the fin on the outside. The interior may have a drywall return from the wall to the window frame.

CAUTION: Many windows in older homes are painted with lead-based paint. Removal of old windows may disturb this paint. Proper precautions must be taken to minimize exposure to dust and debris. Consult state or local authorities and/or go to www.epa.gov/lead for more information.

TOOLS REQUIRED:

• Utility knife



• Phillips and Standard screwdrivers



• Pry bar



• Circular saw



• Hammer

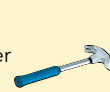

• Putty knife



REMEMBER TO USE APPROPRIATE PERSONAL PROTECTIVE EQUIPMENT.

EXISTING WOOD BRICKMOULD FRAME WINDOW

A. Score paint or varnish between the interior trim and the wall with a sharp utility knife.

NOTE: This will minimize the damage to the interior wall and trim.

B. Remove the interior trim. Using a pry bar and block of wood, remove the interior trim from all four sides of the window including the stool at the bottom of the window. If the interior trim is being reused, pull the nails out through the back side of the board with nipper pliers.

C. Cut the exterior sealant line between the exterior brickmould or trim and the exterior siding or wall cladding.

D. Remove the exterior brickmould or flat trim using a pry bar and block of wood.

Caution: Some windows may come out of the opening as the exterior trim is removed.

E. Remove the window frame using a pry bar if necessary.

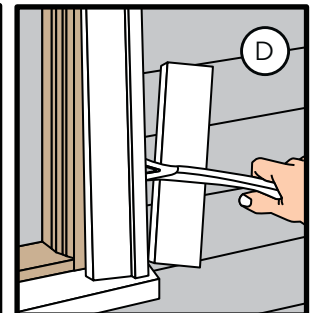
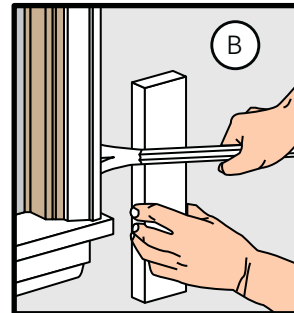

EXISTING NAIL FIN WINDOW REMOVAL

SASH REMOVAL

A. Remove the vent sash and screen from the old window.

B. Remove the fixed sash. In some cases, there are screws holding in the fixed sash. Remove the screws and take out the fixed sash.

NOTE: There may be a need to break the caulking free from around the fixed sash before it can be removed.

C. Remove the division bar by unscrewing the fasteners holding it to the frame. If the screws are not accessible, then use a hacksaw to cut the division bar off at the head and sill flush with the old window frame.

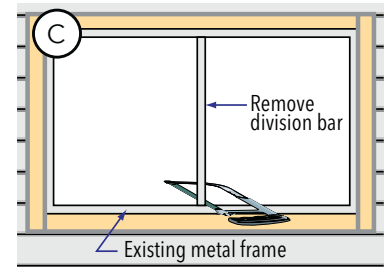
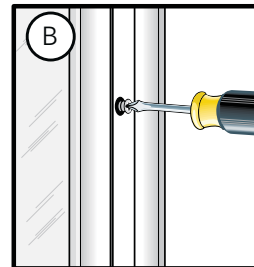

WINDOW WITH EXTERIOR TRIM

D. Remove the existing exterior trim (if applicable). Use a block of wood to protect the exterior wall material. Use a pry bar to remove the existing exterior trim.

E. Remove the nails or screws attaching the window nailing fin to the wall.

F. Remove the window from the opening.

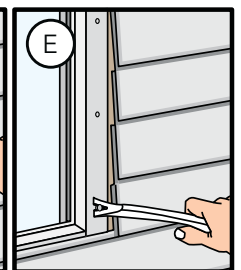
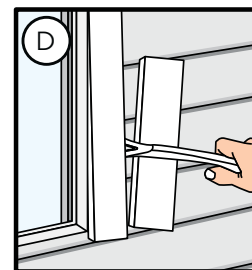

WINDOW WITH NO EXTERIOR TRIM

G. Use a reciprocating saw to cut through sealant line and the nailing fin.

OR

H. Remove siding or cut back the siding a minimum of 3" or far enough to expose the nailing fin. Remove the fasteners attaching the window to the wall.

NOTE: When cutting back the siding, set the saw blade depth 1/8" less than the thickness of the siding. Break the cut ends of the siding off after sawing. DO NOT cut through the existing building wrap.

I. Remove the window from the wall.

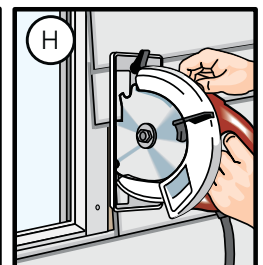
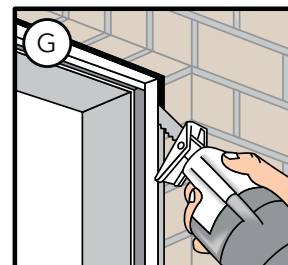

Consult with local providers and authorities to recycle or properly dispose of old window components.



PREPARING FOR NAIL FIN WINDOW INSTALLATION

YOU WILL NEED TO SUPPLY:

- Moisture resistant shims/spacers
- Fasteners (see nail fin anchor instructions at the end of this booklet)
- Closed cell foam backer rod/sealant backer
- #10 x 2" Corrosion-resistant screws (See Anchor Table for use)
- Pella® SmartFlash™ foil backed butyl window and door flashing tape or equivalent
- Low expansion, low pressure polyurethane insulating window and door foam sealant DO NOT use high pressure or latex foams.
- Pella Window and Door Installation Sealant or equivalent high quality, multi-purpose sealant

Other construction materials may be required.

Read and understand the instructions and inspect the wall conditions before you begin.

TOOLS REQUIRED:

- Tape measure
- Level
- Square
- Hammer
- Stapler
- Scissors or utility knife
- Small flat blade screwdriver
- Sealant Gun
- Screw Gun with a Phillips Driver bit
- 1/8" Allen wrench

INSTALLATION WILL REQUIRE (2) OR MORE PERSONS FOR SAFETY REASONS.

Store windows in upright position, out of direct sunlight.

ROUGH OPENING VERIFICATION

- A. Confirm the opening is plumb and level.

NOTE: It is critical the bottom is level and it does not slope to the interior.

- B. Remove dirt, oil or debris from the opening and surrounding wall surfaces.

- C. Confirm the window will fit the opening. Measure all four sides of the opening to make sure it is 1/2" to 3/4" larger than the window in both width and height. On larger openings measure the width and height in several places to ensure the header or studs are not bowed.

NOTE: 1-1/2" or more of solid wood blocking is required around the perimeter of the opening.

Fix any problems with the rough opening before proceeding.

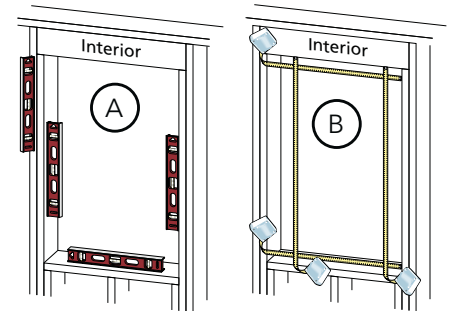

PREPARE THE WINDOW FOR INSTALLATION

- A. Remove plastic wrap and cardboard packaging from window. DO NOT cut checkrail bands (if present) or remove plastic or foam shipping spacers located between the window sash and frame. DO NOT open the window until it is securely fastened.

- B. Inspect the product for any damage such as cracks, dents or scratches. DO NOT install damaged windows.

- C. Remove screens and hardware (if necessary). Label them and set them aside in a protected area.

Windows with Half Screens: From the exterior, pull one side of the screen near the shipping clips until the clips disengage from the frame. Rotate the shipping clips toward the exterior of the screen until they snap free from the screen.

Half screens of some vinyl windows can be removed from the interior.

- D. Fold out installation fin to 90° (units with fold up fin only).

Be careful not to remove or tear the fin corners.

NOTE: If the fin is not at 90°, the window will not line up correctly on the interior.

- E. Curved Units with Fins: Install clips on wood windows with non-structural flex fins or pre-drill holes on wood windows with rigid curved fin. See nail fin anchor instructions at the end of this booklet.

Curved Units with Flexible Fins: Install Clips or pre-drill holes for frame screws Curved units with Rigid Fins: pre-drill holes through fin.

Units with wide EnduraClad Exterior trim and narrow fins with NO pre-punched holes: Install clips or pre-drill holes for frame screws.

See nail fin anchor instruction at the end of this booklet.

Additional preparation may be required for performance upgrade, impact resistant products or to comply with local building code requirements.

- F. Read the entire instruction before proceeding.

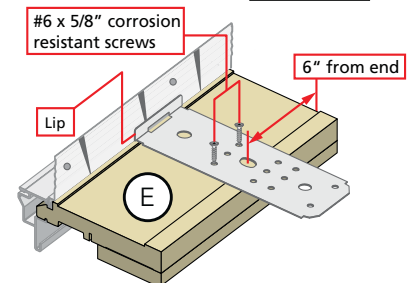
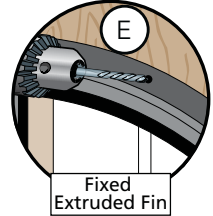
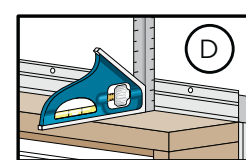
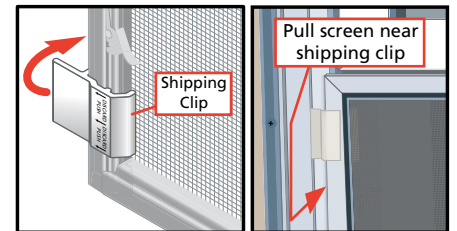

These instructions were developed and tested for use with wall systems designed to manage water. **These instructions are not to be used with any other construction methods or window frame types.** Installation instructions for use with other construction methods or frame types may be obtained from Pella Corporation, your local Pella® retailer or www.installpella.com. Building designs, construction methods, building materials, and site conditions unique to your project may require an installation method different from these instructions and/or additional care. Determining the appropriate installation method is the responsibility of you, your architect, or construction professional.



Always read the Limited Warranty before purchasing or installing Pella® products. By installing this product, you are acknowledging that this Limited Warranty is part of the terms of the sale. Failure to comply with all Pella installation and maintenance instructions may void your Pella product warranty. See Limited Warranty for complete details at www.pella.com/warranty.



NEW CONSTRUCTION INSTALLATION WITH NAIL FIN AFTER BUILDING WRAP

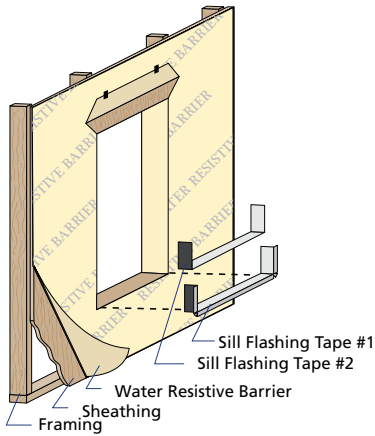

1 PREPARE THE OPENING

Refer to the nail fin installation preparation section at the beginning of this booklet.

A. Cut the building wrap.

Refer to the diagram for other window shapes on the next page.

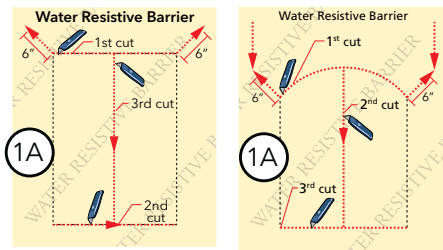

B. Fold the building wrap in at the jambs and staple it in place. Fold the top flap up and temporarily fasten with flashing tape.

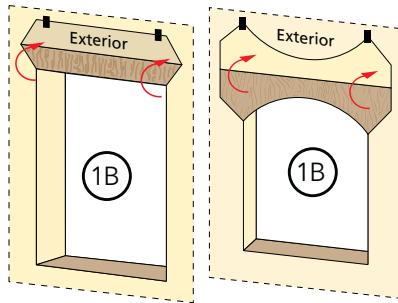

C. Cut 2 pieces of flashing tape 12" longer than opening width.

D. Apply sill flashing tape #1 at the sill extending 1" to the exterior and 6" up each jamb.

E. Cut 1" wide tabs at each corner by tearing the foil 1/2" each way from corner.

F. Apply sill flashing tape #2 overlapping tape #1 by 1" minimum.

NOTE: Press all tape down firmly.

G. Install and level sill shims. Place 1" wide x 1/4" to 3/8" thick shims 1/2" from each side. Keep shims back 1/2" from interior face of window. Place additional shims under each mullion and sliding window interlocker.

For vinyl windows, add shims so maximum spacing is 18".

H. Attach shims to prevent movement after they are level.

NOTE: Improper placement of shims may result in bowing the bottom of the window.

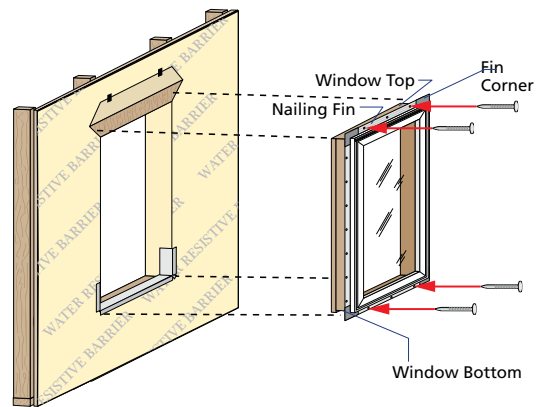
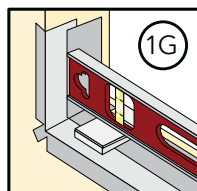
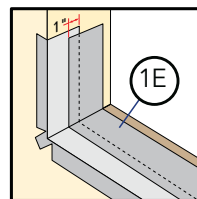
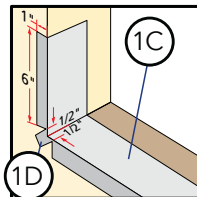

2 SETTING AND FASTENING THE WINDOW

A. Insert the window into the opening on the sill spacers. Center the window between jambs.

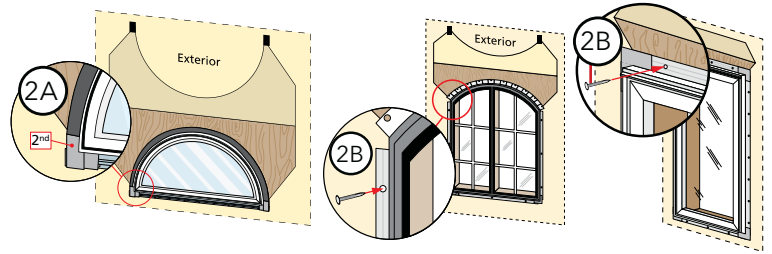

B. Drive two fasteners, one near each end of the top nailing fin. (See nail fin anchor instructions at the end of this booklet)

C. Plumb and square the window using shims at the locations shown. Adjust shims to plumb and square the window. Keep shims 1/2" short of window frame depth.

NOTE: DO NOT shim above the window. Additional shims are required at screw locations for large units and combinations. See the nail fin anchor instructions at the end of this booklet.

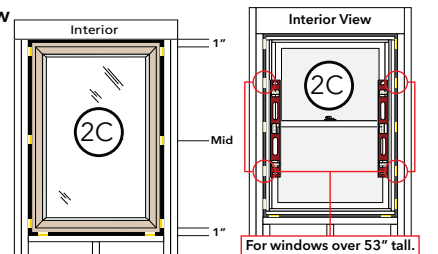

D. Check the window placement by measuring from the interior surface of the window frame or jamb extension to the interior surface of the wall for consistency. If the dimensions are not equal, confirm the fins are folded fully to 90° (if applicable).

E. Drive two fasteners, one near each end of the sill nailing fin.

F. Check window operation.

Vent awning and casement: See lock lever and crank handle instructions at the end of this instruction. Lift the lock lever and turn the crank handle to open the window. Remove the shipping spacers. Open and close the window to test for proper operation.

Double Hung: Cut the checkrail bands (if applicable) and remove shipping spacers. Open, close and tilt the sashes to test for proper operation. Check for equal sash to frame reveal from top to bottom.

NOTE: Adjust shims to correct any issues with plumb, square, operation or reveal.

G. Close and lock the window.

H. Finish driving fasteners into the nailing fin. Refer to the nail fin anchor instructions at the end of this booklet.

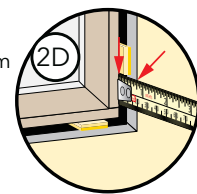

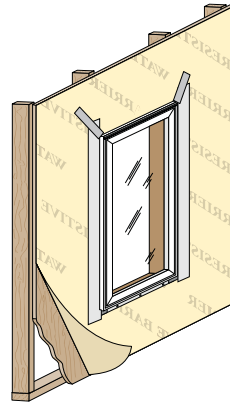
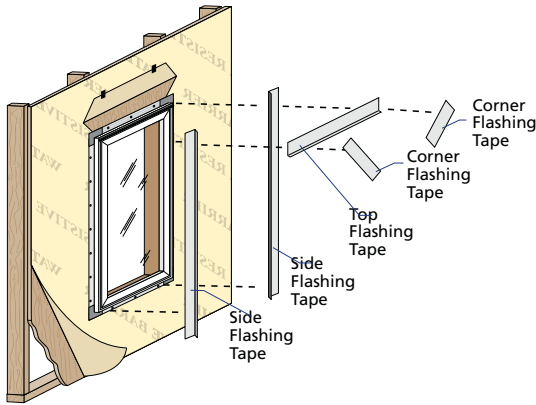

3 INTEGRATING WITH THE BUILDING WRAP

NOTE: Apply flashing tape 1/2" onto frame cladding with fold-up or slide-in fins. Pre-fold flashing tape at 1/2" to assist with application. For siding less than 1/2" thick, adjust the placement of the tape to allow the exterior sealant to cover the tape edge.

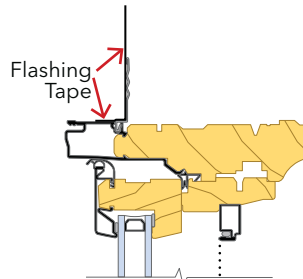

Curved and angle top units without pre-applied fin corners:

A. Cut four 1-1/2" long pieces of flashing tape.

Apply one to each end of sill fin to extend it 1-1/2" past each jamb.

Apply one to the bottom end of each jamb fin beginning 1-1/2" from the end of the fin and lapping over the first piece of flashing tape.

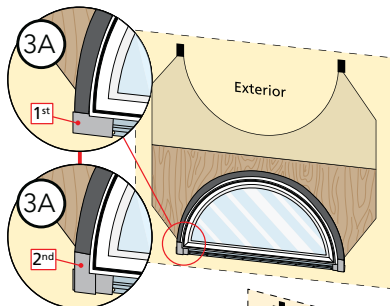

B. Apply straight side flashing tape. Cut two pieces of flashing tape 4" taller than straight sides. Apply tape over the fin and onto weather resistive barrier. Extend tape 2" above and below straight sides.

Angle top Units: On the short side, do not allow the side tape to extend higher than what the top tape will cover.

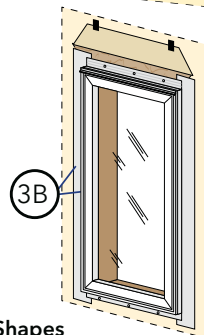

Building Wrap Cutting Patterns for Window Shapes

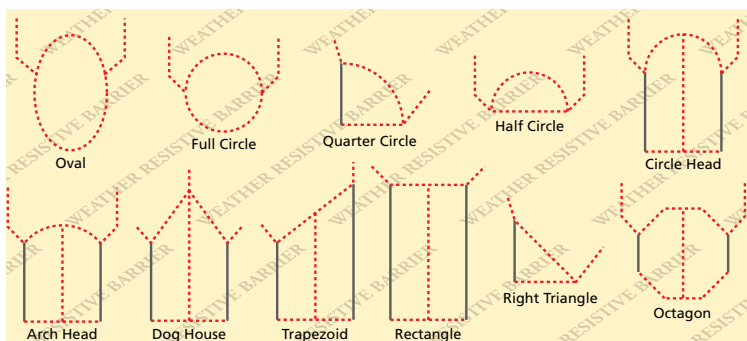

C. Apply top flashing tape.

Rectangular Units: Cut one piece of flashing tape to extend 1" past both side flashing tapes.

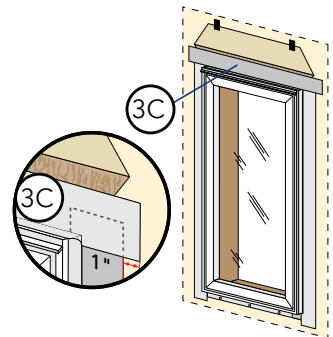

Curved Top Units: Using several short pieces, start taping from the sides of the window working towards the peak. Cut each piece short enough so each piece overlaps the previous piece. Tighter curved frames will require shorter pieces of tape.

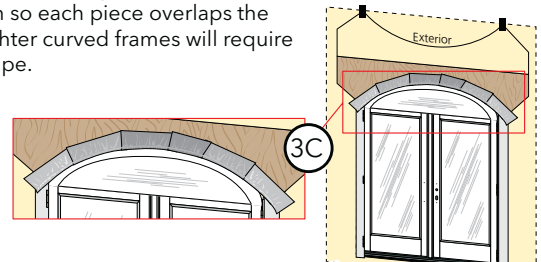

NOTE: DO NOT TAPE OVER BOTTOM NAILING FIN.

D. Fold down top flap of weather resistive barrier.

E. Apply flashing tape to top diagonal cuts. Cut pieces of flashing tape at least 1" longer than each diagonal cut. Lap tape 1" past end of cut onto weather barrier. Overlap multiple pieces of tape by 1" when necessary.

NOTE: PRESS ALL FLASHING TAPE DOWN FIRMLY.

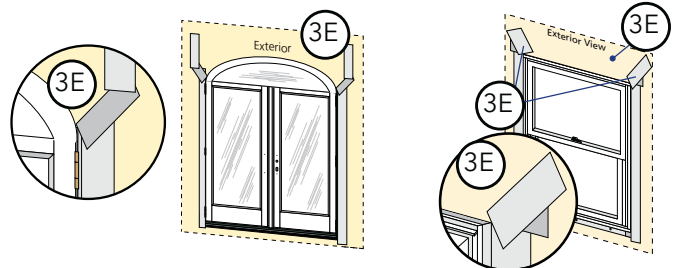

F. Install interior sealant. Refer to the interior sealant instructions at the end of this booklet.

G. Install head flashing, properly incorporating it with the siding and building wrap according to applicable code requirements.

H. Install exterior sealant. (After wall cladding is installed) Refer to the exterior sealant instructions at the end of this booklet.

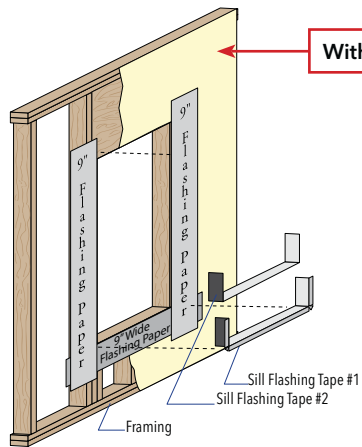

1 PREPARE THE OPENING

Refer to the nail fin installation preparation section at the beginning of this booklet.

- A. **Apply flashing paper at the bottom.** Cut one piece of 9" minimum width flashing paper 18" longer than the width of the opening. Staple it flush with the top of the sill plate.
- B. **Apply flashing paper to the sides.** Cut 2 pieces of 9" minimum width flashing paper 18" longer than the longest straight side of the opening. Center the flashing paper with the opening height and staple one piece flush with the inside edge on both sides.

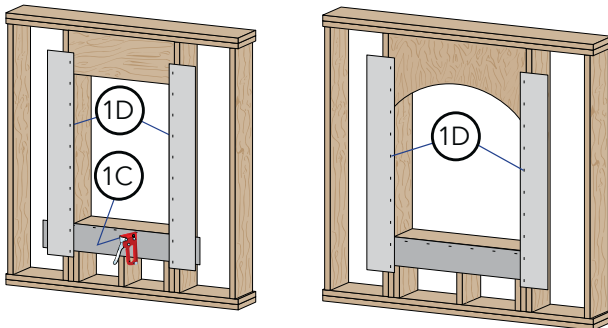

- C. **Cut 2 pieces of flashing tape 12" longer than opening width.**
- D. **Apply sill flashing tape #1** at the sill extending 1" to the exterior and 6" up each jamb.
- E. **Cut 1" wide tabs at each corner** by tearing the foil 1/2" each way from corner.
- F. **Apply sill flashing tape #2** overlapping tape #1 by 1" minimum.

NOTE: Press all tape down firmly.

- G. **Install and level sill shims.** Place 1" wide x 1/4" to 3/8" thick shims 1/2" from each side. Place additional shims under each mullion and sliding window interlocker.

For vinyl windows, add shims so maximum spacing is 18".

- H. **Attach shims to prevent movement** after they are level.

NOTE: Improper placement of shims may result in bowing the bottom of the window.

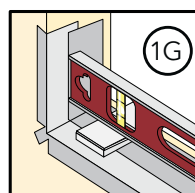
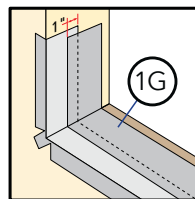
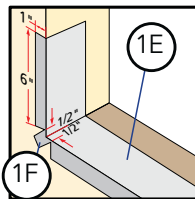

2 SETTING AND FASTENING THE WINDOW

- A. **Insert the window into the opening** on the sill spacers. Center the window between jambs.
- B. **Drive two fasteners**, one near each end of the top nailing fin. (See nail fin anchor instructions at the end of this booklet).

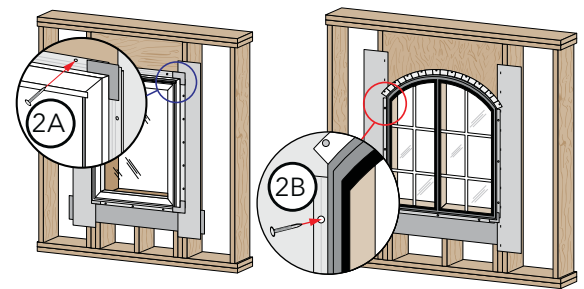

- C. **Plumb and square the window** using shims at the locations shown.

Adjust shims to plumb and square the window. Keep shims 1/2" short of window frame depth.

NOTE: DO NOT shim above the window. Additional shims are required at screw locations for large units and combinations. See the nail fin anchor instructions at the end of this booklet.

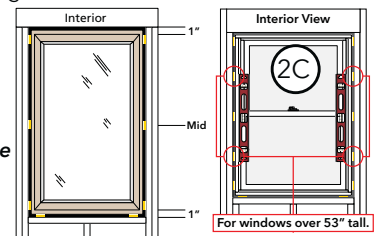

- D. **Check the window placement** by measuring from the interior surface of the window frame or jamb extension to the interior surface of the wall for consistency. If the dimensions are not equal, confirm the fins are folded fully to 90° (if applicable).

- E. **Drive two fasteners**, one near each end of the sill nailing fin.

- F. **Check window operation.**

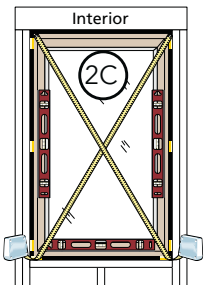
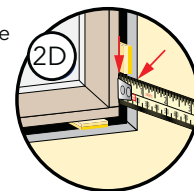

Vent awning and casement:

See lock lever and crank handle instructions at the end of this instruction. Lift the lock lever and turn the crank handle to open the window. Remove the shipping spacers. Open and close the window to test for proper operation.

Double Hung: Cut the checkrail bands (if applicable) and remove shipping spacers. Open, close and tilt the sashes to test for proper operation. Check for equal sash to frame reveal from top to bottom.

NOTE: Adjust shims to correct any issues with plumb, square, operation or reveal.

- G. **Close and lock the window.**

- H. **Finish driving fasteners into the nailing fin.** Refer to the nail fin anchor instructions at the end of this booklet.

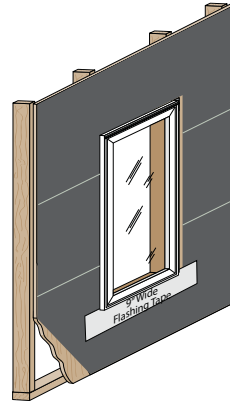
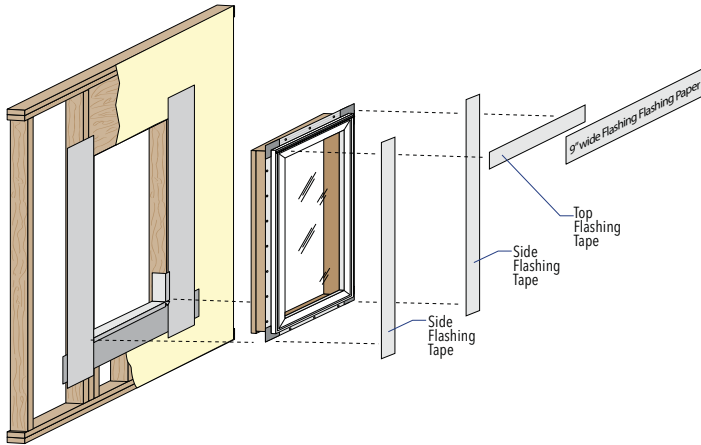

3 INTEGRATING WITH THE FLASHING PAPER

NOTE: Apply flashing tape 1/2" onto frame cladding with fold-up or slide-in fins. Pre-fold flashing tape at 1/2" to assist with application. For siding less than 1/2" thick, adjust the placement of the tape to allow the exterior sealant to cover the tape edge.

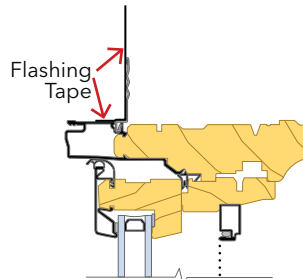

Curved and angle top units without pre-applied fin corners:

A. Cut four 1-1/2" long pieces of flashing tape.

Apply one to each end of sill fin to extend it 1-1/2" past each jamb.

Apply one to the bottom end of each jamb fin beginning 1-1/2" from the end of the fin and lapping over the first piece of flashing tape.

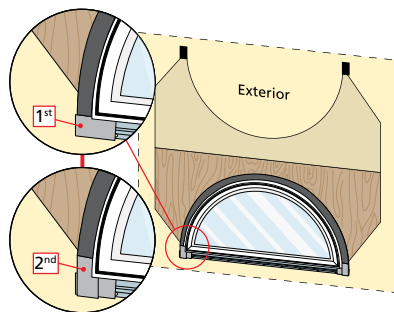

B. Apply straight side flashing tape. Cut two pieces of flashing tape 4" taller than straight sides. Apply tape over the fin and onto the flashing paper. Extend tape 2" above and below straight sides.

Angle top Units: On the short side, do not allow the side tape to extend higher than what the top tape will cover.

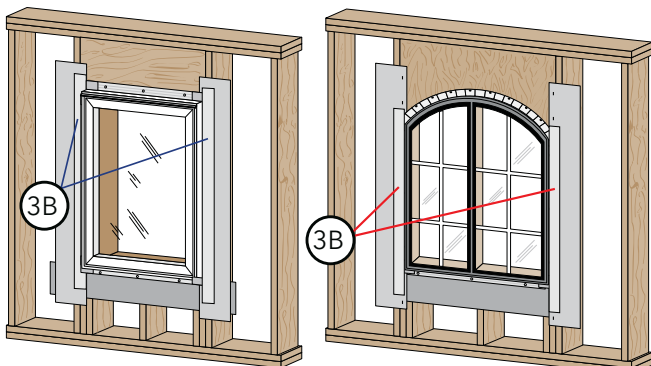

C. Apply top flashing tape.

Rectangular Units: Cut one piece of flashing tape to extend 1" past both side flashing tapes.

Curved Top Units: Using several short pieces, start taping from the sides of the window working towards the peak. Cut each piece short enough so each piece overlaps the previous piece. Tighter curved frames will require shorter pieces of tape.

NOTE: PRESS ALL FLASHING TAPE DOWN FIRMLY.

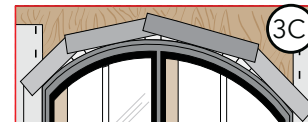
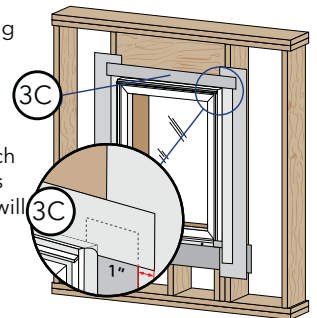

NOTE: DO NOT TAPE OVER BOTTOM NAILING FIN.

D. Apply top flashing paper.

Rectangular windows: Cut one piece of 9" minimum width flashing paper 21" longer than the window width. Center it above the window and flush with the top. Staple it to the header.

Shaped windows: Cut one piece of flashing paper long enough to overlap the side flashing paper by 2" on each side. Cut the bottom of the paper to match the shape of the window (curved only). Center it above the window and flush with the top. Staple it to the header. Ensure the top of the side flashing paper is completely covered by the top flashing paper on each side. Apply multiple pieces of top flashing paper if necessary, overlapping them 6" in watershed fashion.

NOTE: When apply building paper to the wall, ensure the sill flashing paper overlaps the building paper to create a watershed effect.

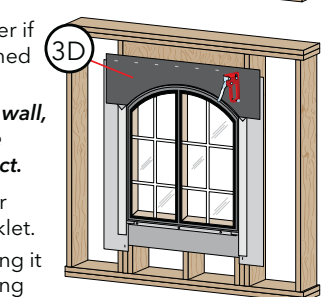
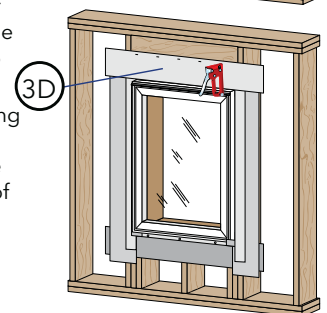
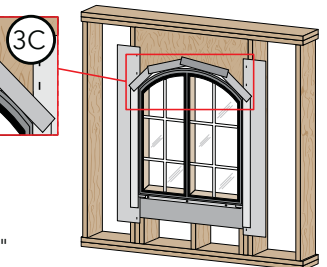

E. Install interior sealant. Refer to the interior sealant instructions at the end of this booklet.

F. Install head flashing, properly incorporating it with the siding and building wrap according to applicable code requirements.

G. Install exterior sealant. (After wall cladding is installed) Refer to the exterior sealant instructions at the end of this booklet.

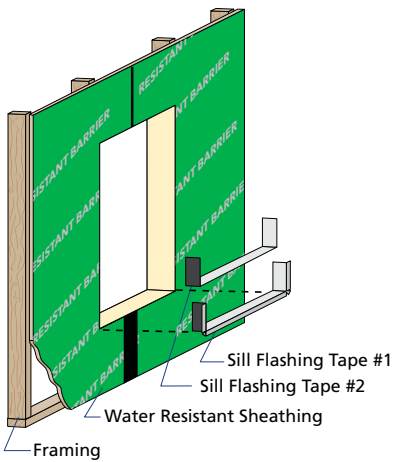

1 PREPARE THE OPENING

Refer to the nail fin installation preparation section at the beginning of this booklet.

- A. **Inspect the joints of the water resistant sheathing.** Joints must be sealed according to the sheathing manufacturer's instructions. Pella Corporation assumes no responsibility for the design, quality or durability of the sheathing system or its joints. Taped joints intersecting with the bottom or sides of the opening must have tape installed before beginning installation.
- B. **Cut 2 pieces of flashing tape 12" longer than opening width.**
- C. **Apply sill flashing tape #1** at the sill extending 2" to the exterior and 6" up each jamb.
- D. **Cut 1" wide tabs** at each corner by tearing the foil 1/2" each way from corner.
- E. **Apply sill flashing tape #2** overlapping tape #1 by 1" minimum.
- F. **Cut 2 pieces of flashing tape.** Make one equal to the height of each side of the opening.
- G. **Apply one piece on each jamb** starting 1" from the exterior of the framing, over the edge of the sheathing and onto the surface of the sheathing.
IMPORTANT: Use a roller to firmly press all flashing tape down until the texture of the sheathing can be seen through the tape.
- H. **Install and level sill shims.** Place 1" wide x 1/4" to 3/8" thick shims 1/2" from each side. Keep shims back 1/2" from interior face of window. Place additional shims under each mullion and sliding window interlocker. For vinyl windows, add shims so maximum spacing is 18".
- I. **Attach shims to prevent movement after they are level.**
NOTE: Improper placement of shims may result in bowing the bottom of the window.

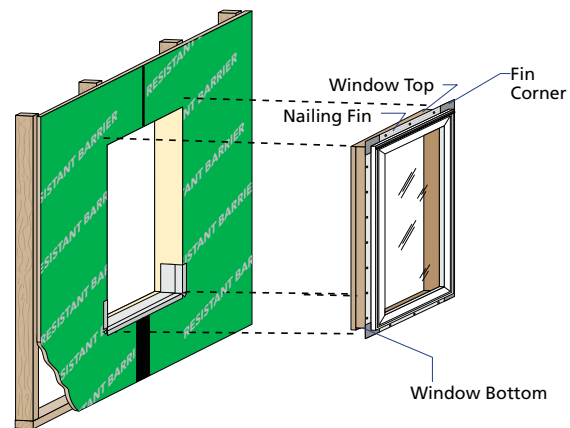
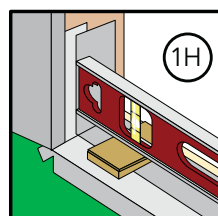
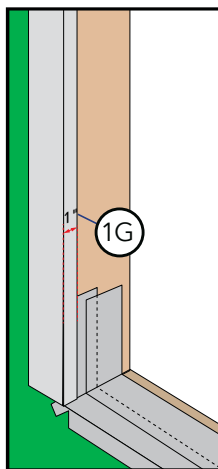
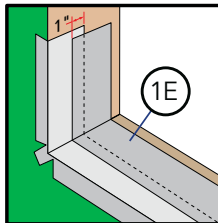
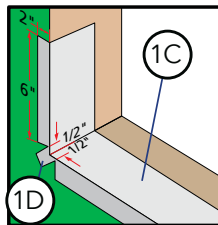

2 SETTING AND FASTENING THE WINDOW

- A. **Insert the window into the opening** on the sill spacers. Center the window between jambs.

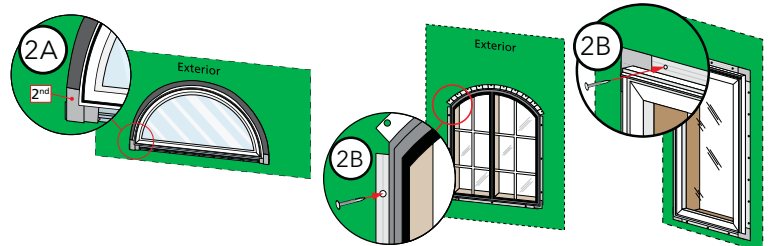

- B. **Drive two fasteners**, one near each end of the top nailing fin. (See the nail fin anchor instructions at the end of this booklet.)

- C. **Plumb and square the window** using shims at the locations shown. Adjust shims to plumb and square the window. Keep shims 1/2" short of window frame depth.

NOTE: DO NOT shim above the window. Additional shims are required at screw locations for large units and combinations. See the anchor schedule at the end of this booklet.

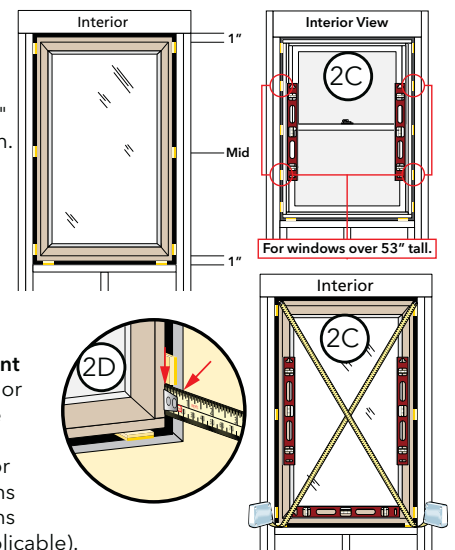

- D. **Check the window placement** by measuring from the interior surface of the window frame or jamb extension to the interior surface of the wall for consistency. If the dimensions are not equal, confirm the fins are folded fully to 90° (if applicable).
- E. **Drive two fasteners** one near each end of the sill nailing fin.
- F. **Check window operation.**
Vent awning and casement: See lock lever and crank handle instructions at the end of this instruction. Lift the lock lever and turn the crank handle to open the window. Remove the shipping spacers. Open and close the window to test for proper operation.
Double Hung: Cut the checkrail bands (if applicable) and remove shipping spacers. Open, close and tilt the sashes to test for proper operation. Check for equal sash to frame reveal from top to bottom.
NOTE: Adjust shims to correct any issues with plumb,
- G. **Close and lock the window.**
- H. **Finish driving fasteners into the nailing fin.** Refer to the nail fin anchor instructions at the end of this booklet.



NEW CONSTRUCTION INSTALLATION WITH NAIL FIN OVER WATER RESISTANT SHEATHING (CONTINUED)

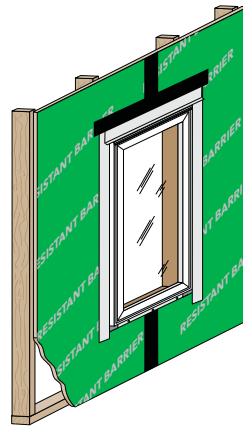
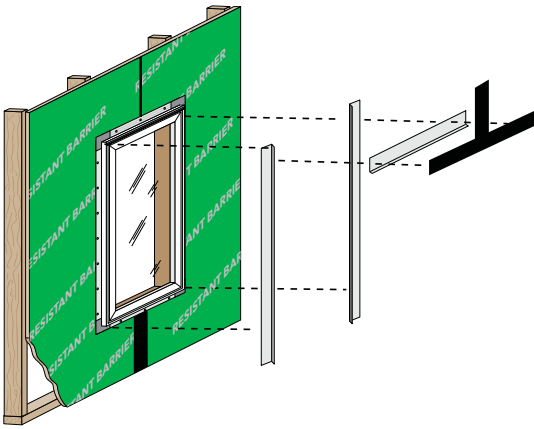

3 SEALING TO THE SHEATHING

NOTE: Apply flashing tape 1/2" onto frame cladding with fold-up or slide-in fins. Pre-fold flashing tape at 1/2" to assist with application. For siding less than 1/2" thick, adjust the placement of the tape to allow the exterior sealant to cover the tape edge.

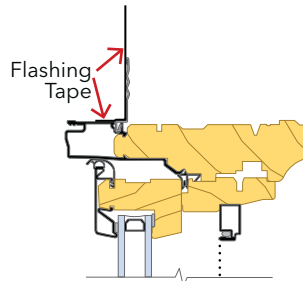

Curved and angle top units without pre-applied fin corners:

- A. Cut four 1-1/2" long pieces of flashing tape.**

Apply one to each end of sill fin to extend it 1-1/2" past each jamb.

Apply one to the bottom end of each jamb fin beginning 1-1/2" from the end of the fin and lapping over the first piece of flashing tape.

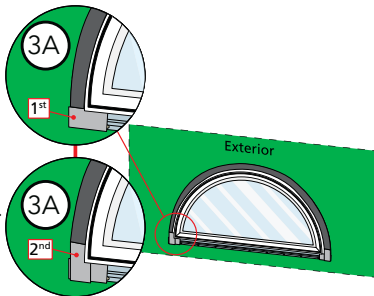

- B. Apply straight side flashing tape.** Cut two pieces of flashing tape 4" taller than straight sides. Apply tape over the fin and onto weather resistive barrier. Extend tape 2" above and below straight sides.

Angle top Units: On the short side, do not allow the side tape to extend higher than what the top tape will cover.

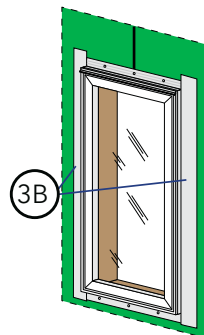

- C. Apply top flashing tape.**

Rectangular Units: Cut one piece of flashing tape to extend 1" past both side flashing tapes.

Curved Top Units: Using several short pieces, start taping from the sides of the window working towards the peak. Cut each piece short enough so each piece overlaps the previous piece. Tighter curved frames will require shorter pieces of tape.

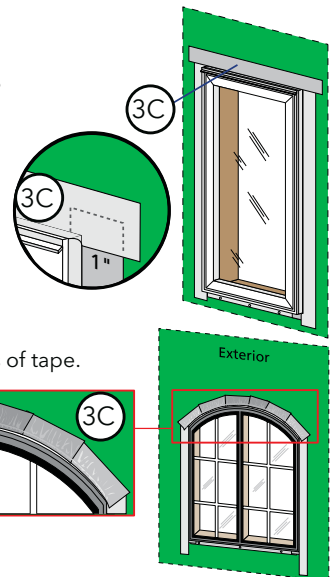

NOTE: DO NOT TAPE OVER BOTTOM NAILING FIN.

- D. Apply a second layer of sheathing manufacturer's joint sealant tape.** Cut one piece so it will extend 1" past the first layer of flashing tape on each side. Overlap the first layer of tape by 1" to create a water shed effect.
- E. Apply sheathing manufacturer's joint sealant tape** to any joints intersecting with the top of the opening, overlapping the head sealant tape in accordance with the manufacturer's instructions.

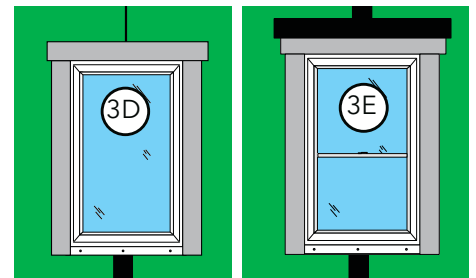

IMPORTANT: Use a roller to firmly press all flashing tape down until the texture of the sheathing can be seen through the tape.

- F. Install interior sealant.** Refer to the interior sealant instructions at the end of this booklet.
- G. Install head flashing,** properly incorporating it with the siding and sheathing according to applicable code requirements.
- H. Install exterior sealant.** (After wall cladding is installed) Refer to the exterior sealant instructions at the end of this booklet.



NEW CONSTRUCTION INSTALLATION INTO MASONRY CONSTRUCTION

FOR THE INSTALLATION OF NEW NAIL FIN WINDOWS INTO MASONRY OPENINGS WITH WOOD BUCKS

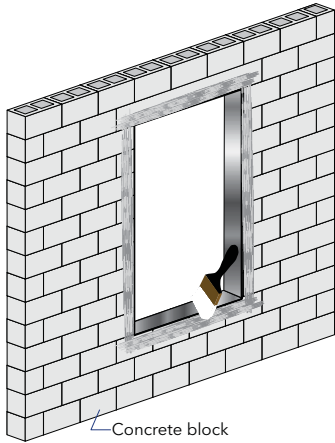

1 PREPARE THE OPENING

Refer to the nail fin installation preparation section at the beginning of this booklet.

- A. **Apply water resistant coating.** Extend the coating into the opening on all four sides and onto the wall surface at least 9". The water resistant coating may be a self-adhered sheet membrane (SASM) or a liquid applied flashing. Ensure continuity between the water resistant coating in the opening and the rest of the wall surface. SASM's must be overlapped in a water shed fashion. Apply all water resistant coatings according to the manufacturer's directions.

NOTE: Allow liquid flashing to dry according to the manufacturer's recommendations.

- B. **Apply 2 beads of sealant** to the masonry opening where the wood buck will be attached.

NOTE: Ensure the sealant is compatible with the water resistant coating.

- C. **Pre-drill and fasten the treated wood buck** to the masonry opening using code-approved fasteners and spacing.

- D. **Apply water resistant coating (optional)** over the wood buck and onto the masonry opening. If using liquid applied flashing, allow it to dry according to the manufacturer's recommendations before proceeding.

- E. **Install and level sill shims.** Place 1" wide x 1/4" to 3/8" thick shims 1/2" from each side. Keep shims back 1/2" from interior face of window. Place additional shims under each mullion and sliding window interlocker.

For vinyl windows, add shims so maximum spacing is 18".

- F. **Attach shims to prevent movement after they are level.**

NOTE: Improper placement of shims may result in bowing the bottom of the window.

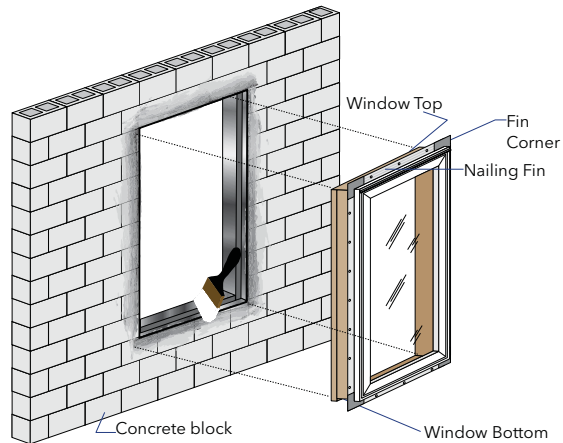
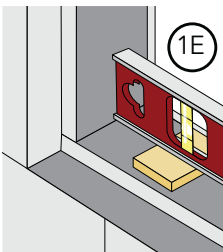
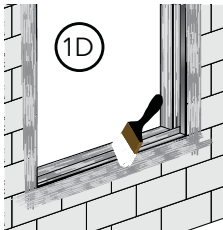
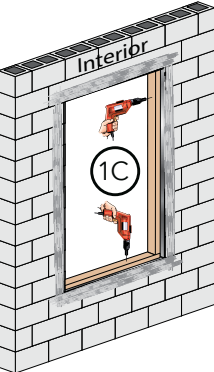
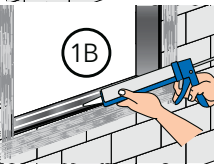
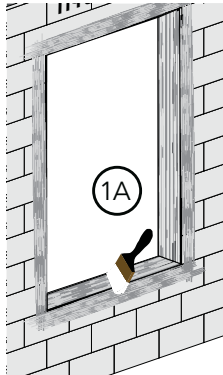

2 SETTING AND FASTENING THE WINDOW

- A. **Insert the window into the opening** on the sill spacers. Center the window between jambs.

- B. **Drive two fasteners**, one near each end of the top nailing fin. See the anchor schedule at the end of this booklet for fastener requirements.

- C. **Plumb and square the window** using shims at the locations shown. Adjust shims to plumb and square the window. Keep shims 1/2" short of window frame depth.

NOTE: DO NOT shim above the window. Additional shims are required at screw locations for large units and combinations. See the nail fin anchor instructions at the end of this booklet.

- D. **Check the window placement by measuring** from the interior surface of the window frame or jamb extension to the interior surface of the wall for consistency. If the dimensions are not equal, confirm the fins are folded fully to 90° (if applicable).

- E. **Drive two fasteners** one near each end of the sill nailing fin.

- F. **Check window operation.**

Vent awning and casement: See lock lever and crank handle instructions at the end of this instruction. Lift the lock lever and turn the crank handle to open the window. Remove the shipping spacers. Open and close the window to test for proper operation.

Double Hung: Cut the checkrail bands (if applicable) and remove shipping spacers. Open, close and tilt the sashes to test for proper operation. Check for equal sash to frame reveal from top to bottom.

NOTE: Adjust shims to correct any issues with plumb, square, operation or reveal.

- G. **Close and lock the window.**

- H. **Finish driving fasteners into the nailing fin.** Refer to the nail fin anchor instructions at the end of this booklet.

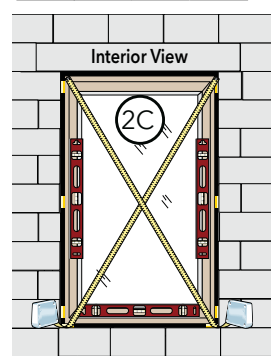
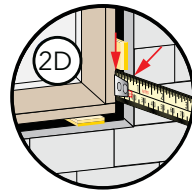
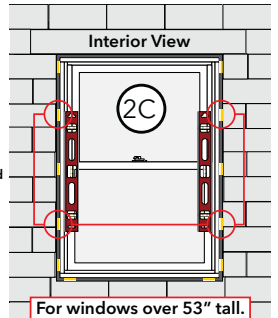
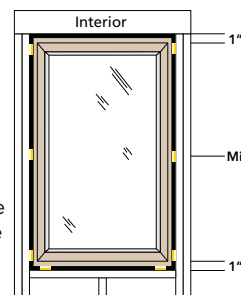
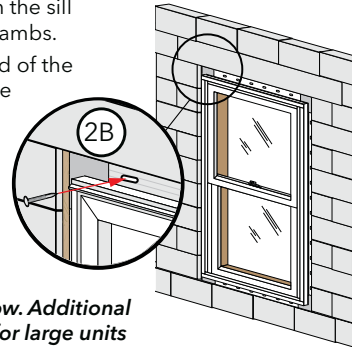



NEW CONSTRUCTION INSTALLATION INTO MASONRY CONSTRUCTION (CONTINUED)

FOR THE INSTALLATION OF NEW NAIL FIN WINDOWS INTO MASONRY OPENINGS WITH WOOD BUCKS

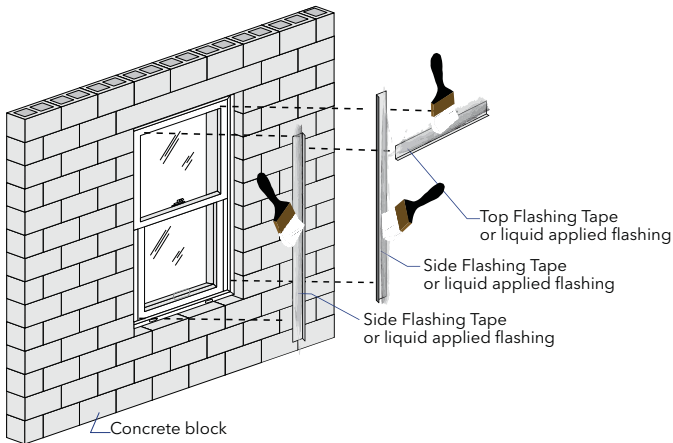

3 SEALING THE TOP AND SIDE NAILING FINS

NOTE: Apply flashing tape or liquid applied flashing 1/2" onto frame cladding with fold-up or slide-in fins. Pre-fold flashing tape at 1/2" to assist with application. For siding less than 1/2" thick, adjust the placement of the tape to allow the exterior sealant to cover the tape edge.

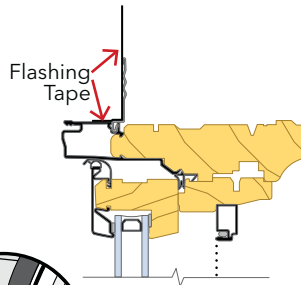

Curved and angle top units without pre-applied fin corners:

- A. Cut four 1-1/2" long pieces of flashing tape.

Apply one to each end of sill fin to extend it 1-1/2" past each jamb.

- B. Apply one to the bottom end of each jamb fin beginning 1-1/2" from the end of the fin and lapping over the first piece of flashing tape.

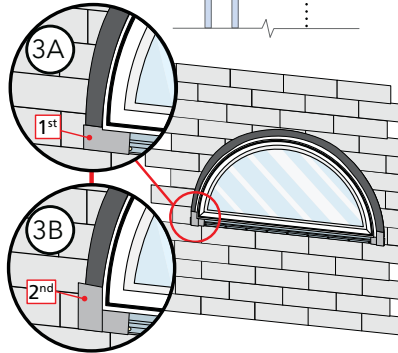

If liquid applied flashing was used to prepare the opening, apply it over the nail fin at jambs and head at this time according to the manufacturer's instructions. Leave the sill nailing fin uncovered. Skip to step 3E.

If the opening was prepared using SASM, follow steps C-D.

- C. Apply straight side flashing tape. Cut two pieces of flashing tape 4" taller than straight sides. Apply tape over the fin and onto liquid applied flashing or SASM. Extend tape 2" above and below straight sides.

Angle top Units: On the short side, do not allow the side tape to extend higher than what the top tape will cover.

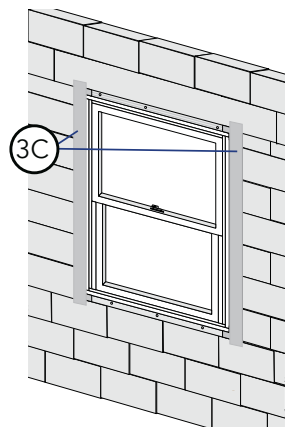

- D. Apply top flashing tape.

Rectangular Units: Cut one piece of flashing tape to extend 1" past both side flashing tapes.

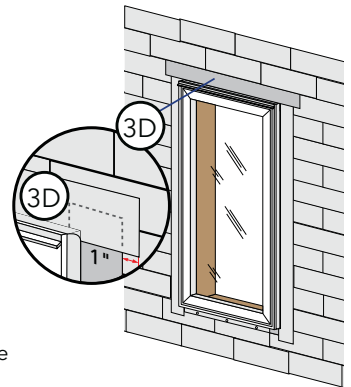

Curved Top Units: Using several short pieces, start taping from the sides of the window working towards the peak. Cut each piece short enough so each piece overlaps the previous piece. Tighter curved frames will require shorter pieces of tape.

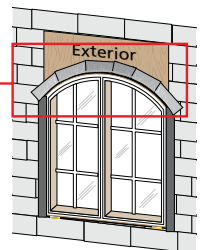
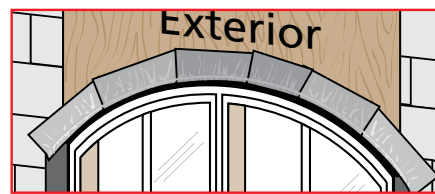

NOTE: DO NOT TAPE OVER BOTTOM NAILING FIN.

NOTE: PRESS ALL FLASHING TAPE DOWN FIRMLY.

Apply SASM or liquid applied water management system in watershed fashion with head flashing and in accordance with manufacturer's recommendations.

- E. Install interior sealant. Refer to the interior sealant instructions at the end of this booklet.
- F. Install head flashing, properly incorporating it with the siding and water management system according to applicable code requirements.
- G. Install exterior sealant. (After wall cladding is installed) Refer to the exterior sealant instructions at the end of this booklet.

NOTE: Frame curved portions of rough opening to support window and wind loads (if applicable).



FULL FRAME REPLACEMENT WITH NAIL FIN

INSTALLATION OF NEW NAIL FIN WINDOWS AFTER THE REMOVAL OF EXISTING WINDOWS AND THE SURROUNDING TRIM OR SIDING

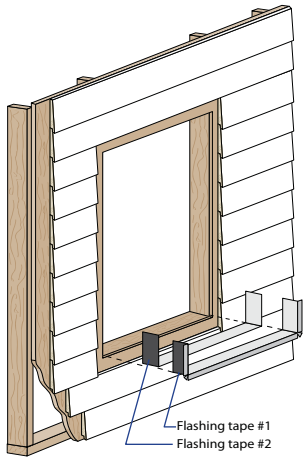

1 PREPARE THE OPENING

Refer to the existing frame removal instruction and nail fin installation preparation sections at the beginning of this booklet.

- Repair the wall surface around the opening (if necessary) by installing new blocking flush with the surface of the existing sheathing and/or repairing the existing building wrap with flashing tape.
- Cut 2 pieces of flashing tape 12" longer than opening width.
- Apply sill flashing tape #1 extending far enough onto the wall surface to overlap the building wrap 1" or onto the top edge of the siding and 6" up each jamb.
- Cut 1" wide tabs at each corner by tearing the foil 1/2" each way from corner.
- Apply sill flashing tape #2 overlapping tape #1 by 1" minimum.
- If existing building wrap is folded into the opening at the jambs, skip to step 1H.
- Cut 2 pieces of flashing tape. Make one equal to the height of each side of the opening.
- Apply one piece on each jamb starting 1" from the exterior of the framing, over the edge of the sheathing and onto the surface of the sheathing.

NOTE: PRESS ALL FLASHING TAPE DOWN FIRMLY.

- Install and level sill shims. Place 1" wide x 1/4" to 3/8" thick shims 1/2" from each side. Keep shims back from interior face of window. Place additional shims under each mullion and sliding window interlocker.

For vinyl windows, add shims so maximum spacing is 18".

- Attach shims to prevent movement after they are level.

NOTE: Improper placement of shims may result in bowing the bottom of the window.

- Apply a continuous, 3/8" tall bead of sealant 1/2" from the edge of the opening at the sides and top only. Do NOT apply sealant at the sill. This step may be omitted if there will be at least 3" of wall surface between the edge of the window frame and the siding after installation.

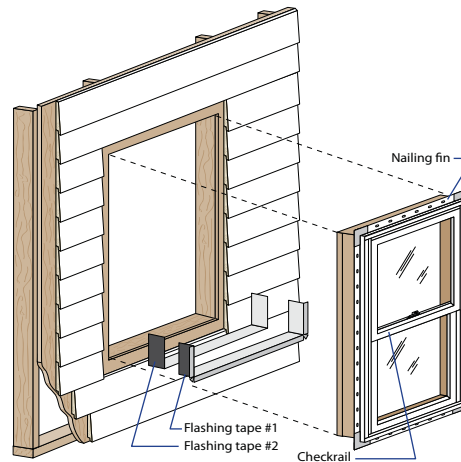
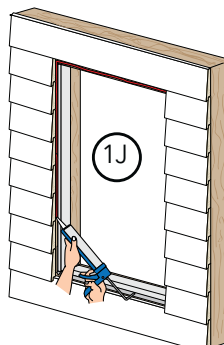
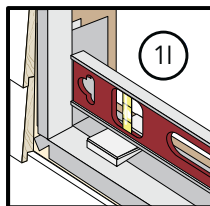
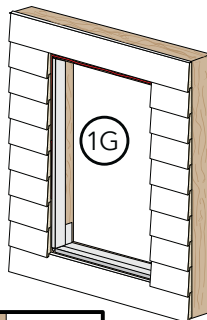
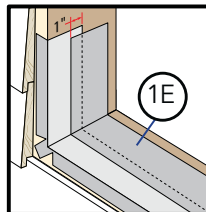
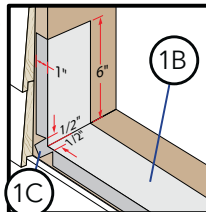

2 SETTING AND FASTENING THE WINDOW

- Insert the window into the opening on the sill spacers. Center the window between jambs.
- Drive two fasteners, one near each end of the top nailing fin. See the nail fin anchor instructions at the end of this booklet for fastener requirements.
- Plumb and square the window using shims at the locations shown. Adjust shims to plumb and square the window. Keep shims 1/2" short of window frame depth.

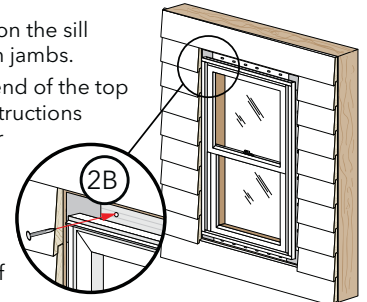

NOTE: DO NOT shim above the window. Additional shims are required at screw locations for large units and combinations. See the nail fin anchor instructions at the end of this booklet.

- Check the window placement by measuring from the interior surface of the window frame or jamb extension to the interior surface of the wall for consistency. If the dimensions are not equal, confirm the fins are folded fully to 90° (if applicable).

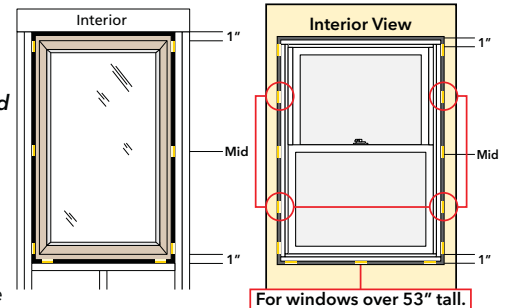

- Drive two fasteners one near each end of the sill nailing fin.
- Check window operation. **Vent awning and casement:** See lock lever and crank handle instructions at the end of this instruction. Lift the lock lever and turn the crank handle to open the window. Remove the shipping spacers. Open and close the window to test for proper operation.

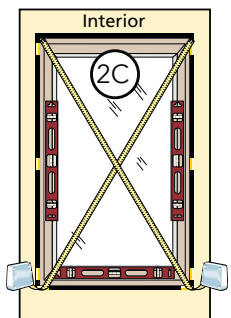
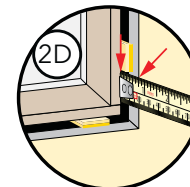

Double Hung: Cut the checkrail bands (if applicable) and remove shipping spacers. Open, close and tilt the sashes to test for proper operation. Check for equal sash to frame reveal from top to bottom.

NOTE: Adjust shims to correct any issues with plumb, square, operation or reveal.

- Close and lock the window.
- Finish driving fasteners into the nailing fin. Refer to the nail fin anchor instructions at the end of this booklet.



FULL FRAME REPLACEMENT WITH NAIL FIN (CONTINUED)

INSTALLATION OF NEW NAIL FIN WINDOWS AFTER THE REMOVAL OF EXISTING WINDOWS AND THE SURROUNDING TRIM OR SIDING

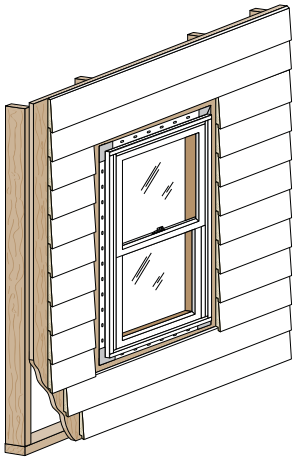

3 SEALING THE TOP AND SIDE NAILING FINS

NOTE: Apply flashing tape 1/2" onto frame cladding with fold-up or slide-in fins. Pre-fold flashing tape at 1/2" to assist with application. For siding less than 1/2" thick, adjust the placement of the tape to allow the exterior sealant to cover the tape edge.

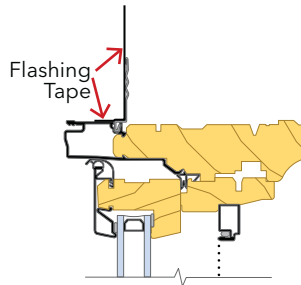

Curved and angle top units without pre-applied fin corners:

A. Cut four 1-1/2" long pieces of flashing tape.

Apply one to each end of sill fin to extend it 1-1/2" past each jamb.

Apply one to the bottom end of each jamb fin beginning 1-1/2" from the end of the fin and lapping over the first piece of flashing tape.

If there is less than 3" between the window frame and the siding, skip to step 3C.

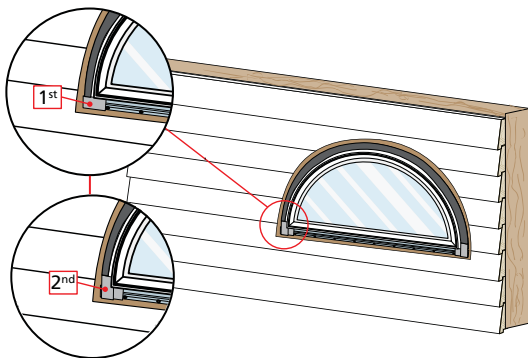

B. Apply straight side flashing tape. Cut two pieces of flashing tape 4" taller than straight sides. Apply tape over the fin and onto weather resistive barrier. Extend tape 2" above and below straight sides.

Angle top units: On the short side, do not allow the side tape to extend higher than what the top tape will cover.

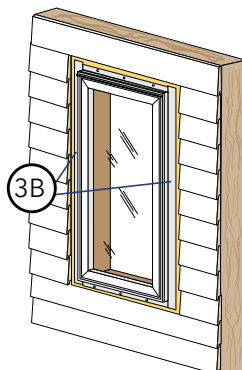

C. Apply top flashing tape.

Rectangular Units: Cut one piece of flashing tape to extend 1" past both side flashing tapes.

Curved Top Units: Using several short pieces, start taping from the sides of the window working towards the peak. Cut each piece short enough so each piece overlaps the previous piece. Tighter curved frames will require shorter pieces of tape.

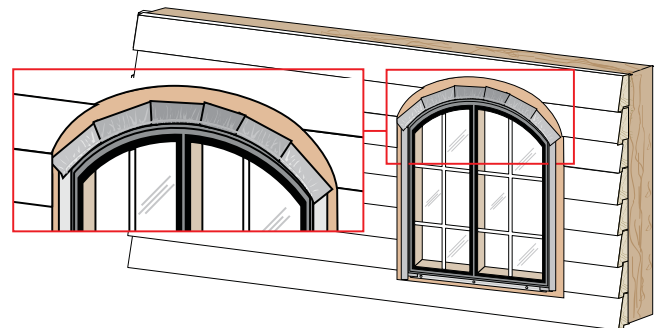
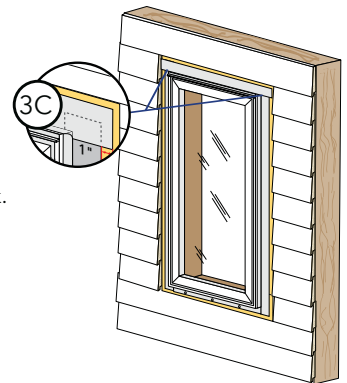

NOTE: DO NOT TAPE OVER BOTTOM NAILING FIN.

NOTE: PRESS ALL FLASHING TAPE DOWN FIRMLY.

- D. **Install head flashing if none exists**, properly incorporating it with the siding and building wrap according to applicable code requirements.
- E. **Install blocking for frame expander** support or solid trim at this time, if applicable.
- F. **Install interior sealant.** Refer to the interior sealant instructions at the end of this booklet.
- G. **Install exterior sealant.** Refer to the exterior sealant instructions at the end of this booklet.
- H. **Install frame expander and receptor** (if applicable). See separate instructions.

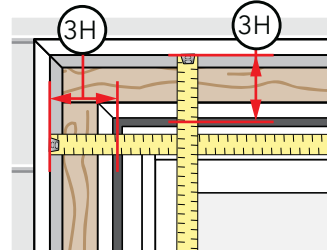
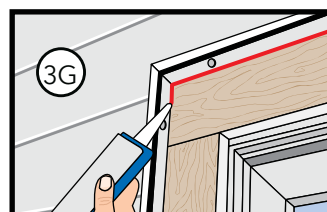



ADVANCED PERFORMANCE AND HURRICANESHIELD IMPACT RESISTANT

Pella® HurricaneShield® Products have been tested in accordance with the large missile impact testing requirements of ASTM E 1886 and ASTM E 1996. Pella HurricaneShield Products are neither hurricane proof nor are they shatter proof. Severe wind and rain may produce temporary conditions which exceed product performance standards. When these units are subjected to intense storms or extreme conditions, which exceed the intended design pressures, air, water and flying debris infiltration may occur.

Advanced performance and HurricaneShield require the use of installation clips or screws through the frame. The use of fins or brickmould is optional and will not affect anchorage requirements. Local building codes may have additional anchoring requirements.

PLACE FRAME SCREWS OR CLIPS AT THE LOCATIONS INDICATED

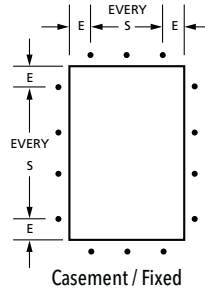

ARCHITECT SERIES® (850), IMPACT RESISTANT WINDOW ANCHOR SPACING INSTRUCTIONS

Product	Edge Spacing (E)	Max. Intermediate Spacing (S)	Fastener	Special Notes
			Wood *	
Casement/Awning	4"	15"	#10 x 3-1/2"	
Fixed Frame	6"	10"	#10 x 3-1/2"	PG 90 up to 60" x 60". Larger sizes are PG 60

* For concrete or masonry, use 3/16" masonry screws with 1-1/4" minimum embedment. Refer to the supplemental instruction included with the unit for securing mullion end anchors (if applicable).

CASEMENT/AWNING OR FIXED FRAME

Fixed Casement windows only: On the room side of fixed windows are a series of screws which secure the sash into the frame. ONE AT A TIME, remove each screw, drill a 1/8" x 1" deep pilot hole into the rough framing, then insert a #10 x 3-1/2" corrosion resistant wood screw.

! WARNING! Removing more than one screw at a time could allow the sash to break free from the window frame which could result in damage to the sash and/or create the potential for personal injury.

Installation Clip Attachment

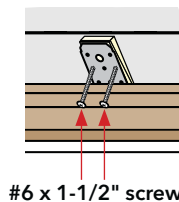
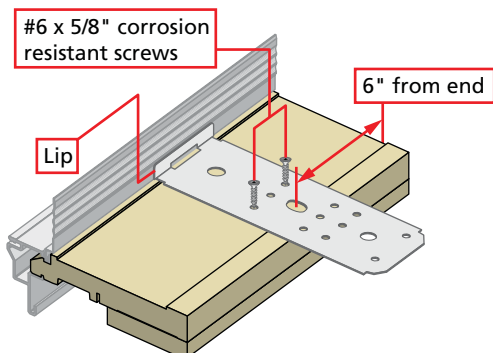

PILOT HOLE LOCATIONS AND SIZES FOR FRAME SCREWS

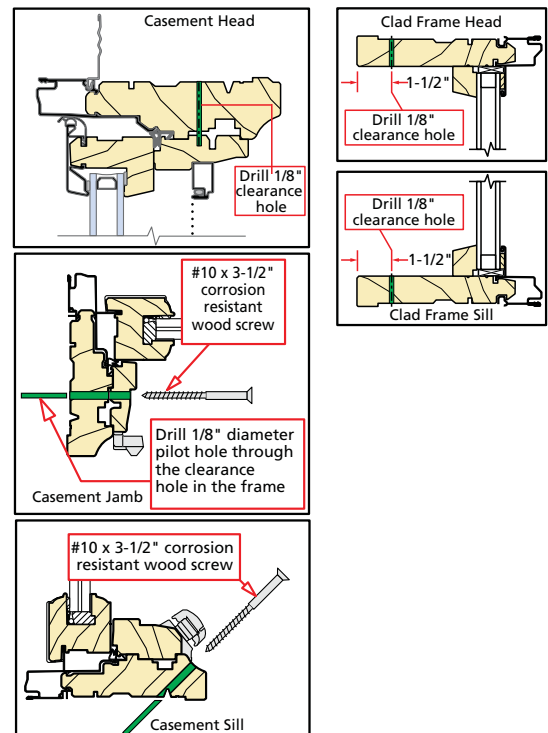



ADVANCED PERFORMANCE AND HURRICANESHIELD IMPACT RESISTANT

Pella® HurricaneShield® Products have been tested in accordance with the large missile impact testing requirements of ASTM E 1886 and ASTM E 1996. Pella HurricaneShield Products are neither hurricane proof nor are they shatter proof. Severe wind and rain may produce temporary conditions which exceed product performance standards. When these units are subjected to intense storms or extreme conditions, which exceed the intended design pressures, air, water and flying debris infiltration may occur.

Advanced performance and HurricaneShield require the use of installation clips or screws through the frame. The use of fins or brickmould is optional and will not affect anchorage requirements. Local building codes may have additional anchoring requirements.

Place frame screws or clips at the locations indicated.

(Double/Single/Simulated Hung Shown)

1. Center locations on jambs not required for units with frame height ≤ 42".

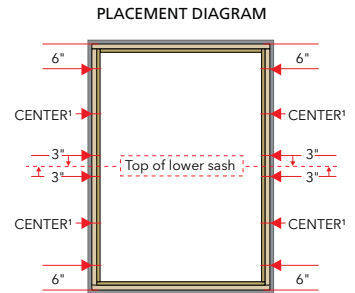

ARCHITECT SERIES® (850), IMPACT RESISTANT WINDOW ANCHOR SPACING INSTRUCTIONS

Product	Edge Spacing (E)	Max. Intermediate Spacing (S)	Fastener	Special Notes
			Wood *	
Double, Single or Simulated Hung	6"	see drawing above	#10 x 3"	(2) #8 x 2-3/4" screws through check rail strike at each side (1) #8 x 2-3/4" screws through each lower jamb liner block (1) #10 x 7/8" pan head screw into the balance shoe (Simulated Hung Only)

* For concrete or masonry, use 3/16" masonry screws with 1-1/4" minimum embedment. Refer to the supplemental instruction included with the unit for securing mullion end anchors (if applicable).

- A. **Simulated-hung only:** Remove the simulated-hung lock by removing the four screws from each lock.
- B. **Remove the lower sash.** Raise the sash 6" or more and locate the two finger slides on the lower sash check rail. At the same time, slide each toward the center of the sash to disengage the wash lock stops and pull the sash towards the room side. The sash will tilt from the bottom.
- C. **With the sash parallel to the floor,** lift one side of the lower sash until the terminal is removed from the balance shoe. Continue to lift the sash up until the terminal is released from the opposite side of the sash and can be removed from the shoe. Lift the sash up and out of the window frame. Set the sash in a safe location.
- D. **Shim behind the check rail strike on both jambs.** Drill pilot holes through strike (located in interior balance channel) and window frame into the rough opening. Install screws.
- Note: Be careful not to damage the balance cord when installing screws.**

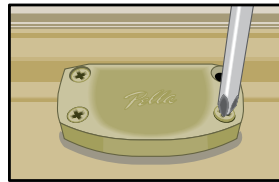

Finger slides are located on the top, back side of the lower sash.

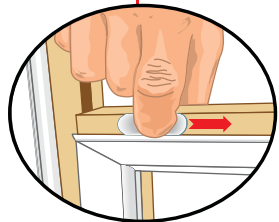

- E. **Gently pry out the bottom of the jamb insert to reveal the jamb liner block.** Shim behind the jamb liner block and drill a pilot hole through the frame using the jamb liner block as a guide. Install screws into the block. Reinstall the insert. Repeat on the other jamb.

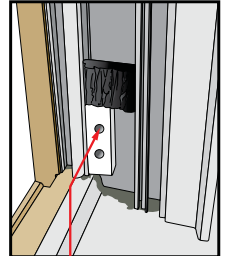

Drill a 1/8" x 1" deep hole and install a #8 x 2-3/4" screw

- F. **Simulated and Single-hung only:** Drill 1/8" x 1" deep pilot hole through the upper sash balance shoe. Install panhead screw into the balance shoe.

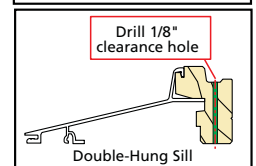
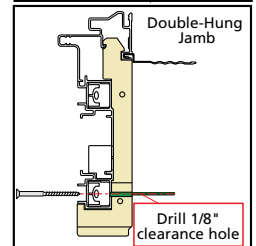
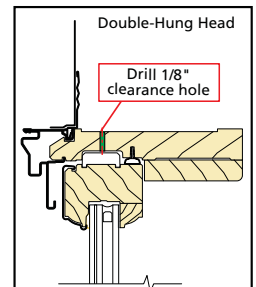
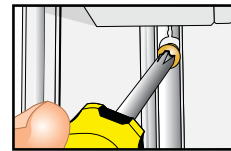

Double/Single or Simulated Hung

Clip Anchor Method Only

#6 x 5/8" corrosion resistant screws

6" from end

Lip

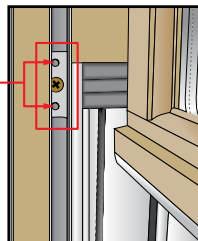
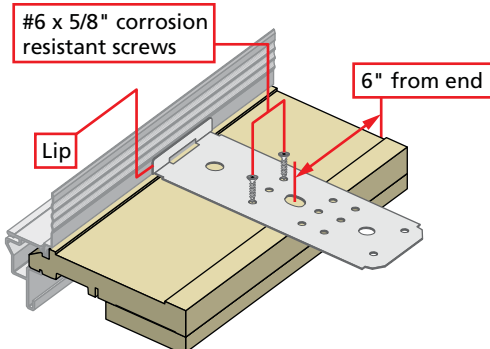

Drill 1/8" x 1" deep holes and install two #8 x 2-3/4" screws

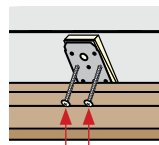

#6 x 1-1/2" screw



ADVANCED PERFORMANCE AND HURRICANESHIELD IMPACT RESISTANT

Pella® HurricaneShield® Products have been tested in accordance with the large missile impact testing requirements of ASTM E 1886 and ASTM E 1996. Pella HurricaneShield Products are neither hurricane proof nor are they shatter proof. Severe wind and rain may produce temporary conditions which exceed product performance standards. When these units are subjected to intense storms or extreme conditions, which exceed the intended design pressures, air, water and flying debris infiltration may occur.

Advanced performance and HurricaneShield require the use of installation clips or screws through the frame. The use of fins or brickmould is optional and will not affect anchorage requirements. Local building codes may have additional anchoring requirements.

Place frame screws or clips at the locations indicated.

(Sliding Window Shown)

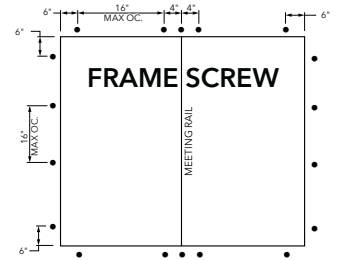

PELLA® 350 SERIES WINDOW ANCHOR SPACING INSTRUCTIONS

Product	Edge Spacing (E)	Max. Intermediate Spacing (S)	Fastener	Special Notes
			Wood *	
Casement/Awning	6"*	16"*	#10 x 2-1/2" Pan Head (provided)	
Sliding and Fixed Window	6"*	16"*	#10 x 2-1/2" Pan Head (provided)	Place 2 screws 4" from the center of the meeting rail at the head and sill of sliding windows.
Double- and Single-Hung	6"*	16"*	#10 x 2-1/2" Pan Head (provided)	

* = Use Factory Drilled installation holes if present.

For concrete or masonry, use 3/16" masonry screws with 1-1/4" minimum embedment.

Install hole plugs after driving screws.

Refer to the supplemental instruction included with the unit for securing mullion end anchors (if applicable).

PILOT HOLE LOCATIONS AND SIZES

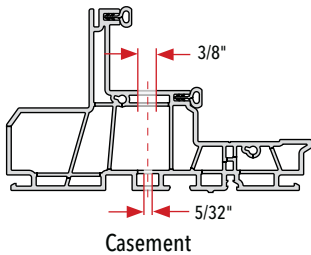

Casement

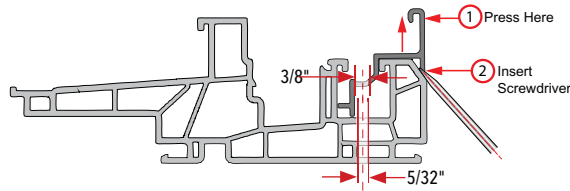

Remove sill riser (if applicable)
Double/Single Hung

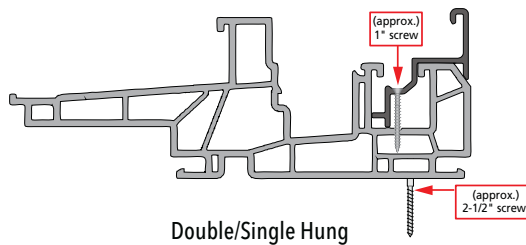

Double/Single Hung

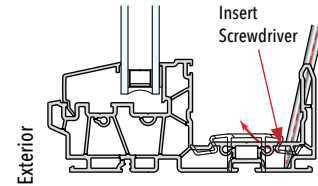

Remove vent track
(if applicable)
Sliding Window

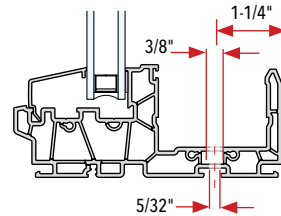

Sliding Window

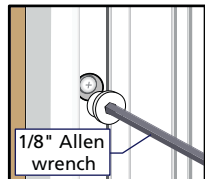

1/8" Allen wrench

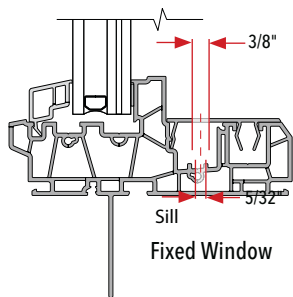

Fixed Window

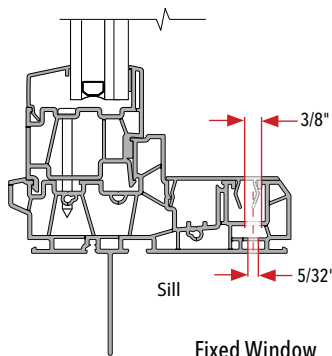

Fixed Window

Double and Single hung Impact Installation:

Place (1) #6 x 1" screw in each pre-drilled hole of the sill riser. Do not over tighten screws.

Drive screws into head and jamb clips. Drive two #8 x 1/2" screws (provided) into the row of pre-punched holes which is 3/4" from the interior face of the frame. DO NOT drive screws in the sill clips. Doing so could allow water leakage.

Clip Anchor Method Only

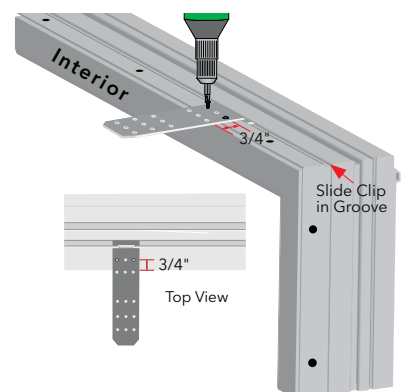



Interior Sealant Instructions

CAUTION: Use low pressure polyurethane window and door insulating foams. Follow the directions on the can. Do not use high pressure or latex foams.

- Insert the nozzle or straw between the rough opening and window frame from the interior. Use a pliers (if necessary) to compress the end of a straw tube to allow it to fit in tight openings.
- Place a 1" deep bead of foam approximately 1" from the interior of the frame to allow for expansion. DO NOT fill the entire depth of the rough opening cavity.

NOTE: Apply foam between the frame and rough opening, NOT between jamb extensions and the rough opening.

- To ensure a continuous interior seal, apply sealant over the interior surface of any shims or clips interrupting the foam seal.

Backer rod (as necessary) and sealant can be used in place of the low expansion foam to create the interior seal. However, foam has greater insulating properties. Fiberglass batt or similar insulation is not recommended as it can absorb water and does not act as an air seal.

NOTE: Use a low odor, paintable sealant such as Pella Window and Door Installation Sealant.

Re-check window operation and remove shipping spacers after foam installation. Excess foam may be removed with a serrated knife after it cures.

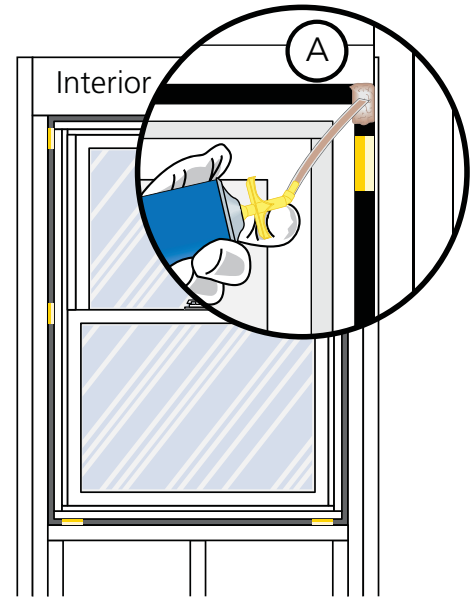

Exterior Sealant Instructions

CAUTION: Use a high quality, multi-purpose exterior sealant such as Pella Window and Door Installation Sealant. Follow the directions on the cartridge.

When applying siding, brick veneer, flashing, or other exterior finish materials, leave adequate space between the window frame and the material for sealant application.

- Insert backer rod 3/8" deep in the space around the window. Backer rod adds shape and controls the depth of the sealant line.
- Apply a continuous bead of sealant to the entire perimeter of the window.
- Shape, tool and clean excess sealant. When finished, the sealant should be the shape of an hourglass.

NOTE: The siding details below apply to windows without a J-mould as part of the frame. The J-mould frame is only intended for vinyl or metal sidings where the siding is extended behind the J-mould portion of the frame. The J-mould should be removed and replaced with backer rod and sealant with all other siding or trim types.

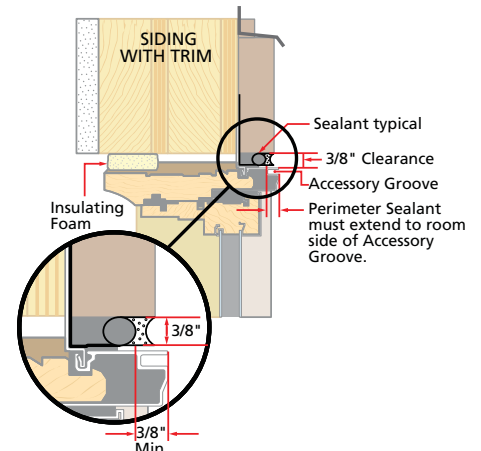
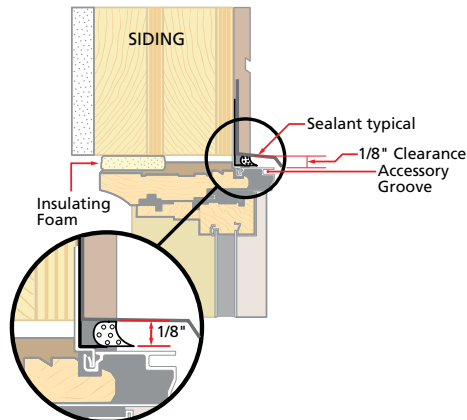
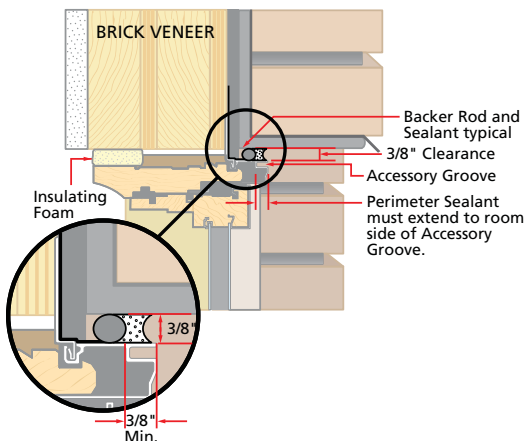
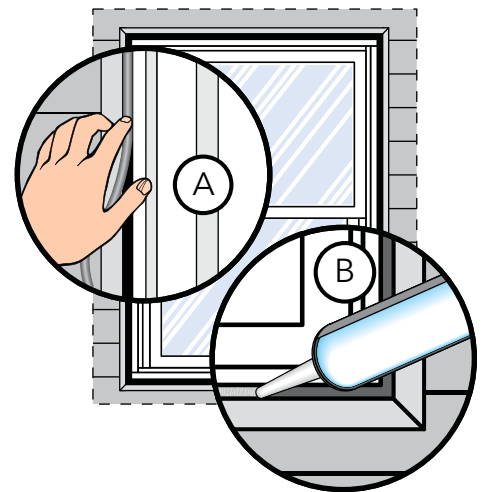



INSTALLING ROTO COVER AND CRANK

Note: Finish the interior of the window and allow the window to dry before proceeding with these instructions. (To open the window for finishing, partially insert the lock handle into the jamb, unlock the unit, temporarily attach the crank handle and turn to open.)

- Place the cover over the operator stud and snap into place. Position the pocket end of the cover into place.
Note: If the cover does not have the screw hole, apply pressure on the pocket end of the cover to snap the cover into place and proceed to step C.
- Insert the provided screw into the hole in the bottom of the pocket. Use a # 1 Phillips screwdriver to secure the pocket screw snug against the bottom of the pocket to avoid scratching the crank handle knob. DO NOT over tighten.
- Use a medium size flat-blade screwdriver to loosen the set screw in the crank handle.
- Slide the crank handle onto the stud. Unlock, open window, then close and lock window.
- Fold the crank handle down and check alignment of knob with the pocket.
Note: You may need to adjust the crank position on the stud until the correct alignment is achieved.
- Open the crank and tighten the set screw.
- After the final installation, fold the crank over and snap the knob into the pocket.

Note: Even with the window open the crank can be folded to avoid interfering with the window treatments.

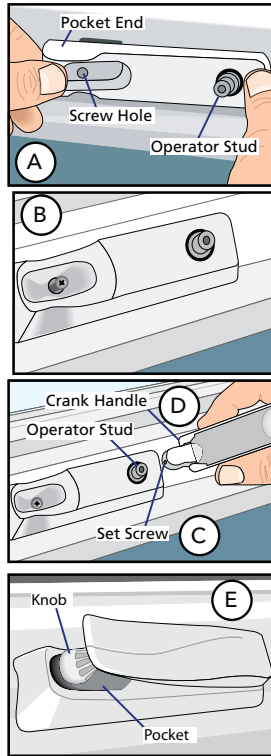

LOCK LEVER INSTALLATION AND REMOVAL

- Unlock and open the window.
- Place the lock lever in the locked position.
- From the exterior of the window, insert a small flat-blade screwdriver into the slot behind the lock lever.
- Pry the cam away from the side of the window by rotating the screwdriver a quarter turn. This will release the hook in the lever from the cam hook.
- Remove the lock lever by pulling it toward the interior of the building.
- To install a lock lever, hold it in the lock position and insert it, from the interior, into the slot until it snaps into the cam.

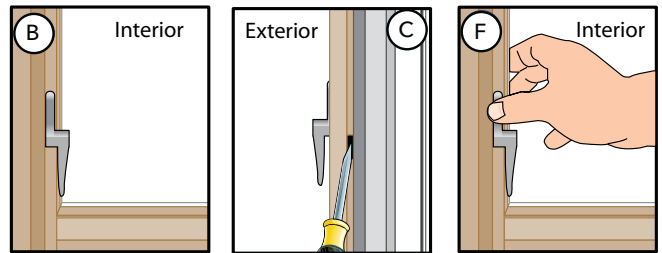
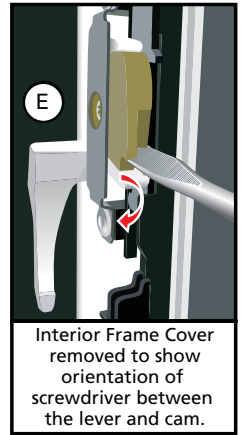

Exterior Finish of Existing Frame (Pocket Replacement)

It is the responsibility of the homeowner, contractor or installer to ensure any exposed unfinished wood is covered or finished. Possible methods include, however are not limited to, covering with aluminum coil stock or painting.

Cleaning Instructions

GLASS—Remove any protective film and labels and clean the glass, using a soft, clean, grit-free cloth and mild soap or detergent. Be sure to remove all liquid by wiping dry or use a clean squeegee.

Pella® ALUMINUM CLAD OR IMPERVIA FRAMES—The interior and exterior frame and sash are protected with a tough factory finish. Clean this surface with mild soap and water. Stubborn stains and deposits may be removed with mineral spirits. DO NOT use abrasives. DO NOT scrape or use tools that might damage the surface.

Encompass by Pella®/Thermastar by Pella® and Pella® 350 Series Windows **FRAMES**—The vinyl frame may be cleaned using the same method as the glass. For stubborn dirt, a “non-abrasive” cleaner such as Bon-Ami® or Soft Scrub® may be used. Do not use solvents such as mineral spirits, toluene, xylene, naphtha or muriatic acid as they can dull the finish, soften the vinyl and/or cause failure of the insulated unit seal. Keep door tracks clear of dirt and debris. Keep weep holes open and clear of obstructions.

Use of inappropriate solvents, brickwash or cleaning chemicals will cause adverse reactions with window and door materials and voids the Limited Warranty.

Interior Finish (Wood Windows)

If products cannot be finished immediately, cover with clear plastic to protect from dirt, damage and moisture. Remove any construction residue before finishing. Sand all wood surfaces lightly with 180 grit or finer sandpaper. DO NOT use steel wool. BE CAREFUL NOT TO SCRATCH THE GLASS. Remove sanding dust. Pella products must be finished per the below instructions; failure to follow these instructions voids the Limited Warranty.

- On casement and awnings, it is optional to paint, stain or finish the vertical and horizontal sash edges.
- On single-hungs and double-hungs, do not paint, stain or finish the vertical sash edges, any finish on the vertical sash edges may cause the sash to stick; it is optional to paint, stain or finish the horizontal sash edges.

Note: To maintain proper product performance do not paint, finish or remove the weatherstripping, mohair dust pads, gaskets or vinyl parts. Air and water leakage will result if these parts are removed. After finishing, allow venting windows and doors to dry completely before closing them.

Pella Corporation is not responsible for interior paint and stain finish imperfections for any product that is not factory-applied by Pella Corporation. For additional information on finishing see the Pella Owner's Manual or go to www.pella.com.

Care and Maintenance

Care and maintenance information is available by contacting your local Pella retailer. This information is also available at www.pella.com.

IMPORTANT NOTICE

Because all construction must anticipate some water infiltration, it is important that the wall system be designed and constructed to properly manage moisture. Pella Corporation is not responsible for claims or damages caused by anticipated and unanticipated water infiltration; deficiencies in building design, construction and maintenance; failure to install Pella products in accordance with Pella's installation instructions; or the use of Pella products in wall systems which do not allow for proper management of moisture within the wall systems. The determination of the suitability of all building components, including the use of Pella products, as well as the design and installation of flashing and sealing systems are the responsibility of the Buyer or User, the architect, contractor, installer, or other construction professional and are not the responsibility of Pella.

Pella products should not be used in barrier wall systems which do not allow for proper management of moisture within the wall systems, such as barrier Exterior Insulation and Finish Systems (EIFS) (also known as synthetic stucco) or other non-water managed systems. Except in the states of California, New Mexico, Arizona, Nevada, Utah and Colorado, Pella makes no warranty of any kind on and assumes no responsibility for Pella windows and doors installed in barrier wall systems. In the states listed above, the installation of Pella Products in barrier wall or similar systems must be in accordance with Pella's installation instructions.

Product modifications that are not approved by Pella Corporation will void the warranty.